

Beach House

by Blackbird Designs



Finished Size: 62"x76"

moda

FINISHED SIZE: 62"x76"

Beach House

by Blackbird Designs



- Read instructions before beginning a project.
- All instructions include 1/4" seam allowance.
- Label each group of cut pieces.
- Press as you go. Press seams in one direction toward the darker fabric.

Please read **all** instructions before beginning this project. Labeling pieces as they are cut is the key to success with this quilt. The quilt is constructed in sections. Each section will require "parts" from various fabrics. Fabrics for the 2 applique blocks will come from the "scraps" after cutting the various pieces for the quilt. There will be ample "scraps" to choose from for applique.

3 SIMPLE STEPS TO SUCCESS WITH THIS PROJECT

- STEP 1** Label all of the various pieces as they are cut.
- STEP 2** Applique the blocks using your favorite method of applique. Trim completed applique blocks to the correct size.
- STEP 3** Begin construction of the 4 sections and borders of this quilt.

Cutting

From each fat quarter cut the following:

Fabric 1 Blue Small Floral
 Cut 1- 6 1/2" x 12 1/2" rectangle
 1- 6 7/8" x 6 7/8" square,
 cut once diagonally

Fabric 2 Red Small Floral
 Cut 2- 6 7/8" x 6 7/8" squares,
 cut once diagonally

Fabric 3 Tan/ Red Flower Print
 Cut 2- 7" x 14" rectangles*
 1- 6 7/8" x 6 7/8" square,
 cut once diagonally

Fabric 4 Green Large Floral
 Cut 1- 9" x 9" square

Fabric 5 Green Sampler
 Cut 1- 14" x 14" square,
 cut twice diagonally
 2 extra pieces

Fabric 6 Purple Small Floral
 Cut 1- 6 1/2" x 12 1/2" rectangle
 1- 6 7/8" x 6 7/8" square,
 cut once diagonally

LABEL

- 1- Section 2
- 1- Section 1
- 1- Section 2
- 2- Section 1
- 1- Section 4
- 1- Section 1
- 1-Section 3
- 1-Section 3
- 1-Section 4
- 1- Section 3
- 2- Section 1
- 1- Section 2
- 1- Section 1
- 1- Section 2

LABEL

- 1- Section 1
- 2- Section 2
- 1- Section 3
- 1-Section 1
- 2-Section 4

10 Half Yard Cuts

Fabric 9 Brown Sampler
 Cut 2- 14" x 14" squares,
 cut twice diagonally
 4 extra pieces - fabric is directional

Fabric 10 Brown Dot
 Cut 1- 8 1/2" x WOF strip
 Subcut 1- 8 1/2" x 12 1/2" strip Bottom Border
 2- 8 1/2" x 6 1/2" rectangles Bottom Border
 1- 6 7/8" x 6 7/8" square,
 cut once diagonally 2-Section 1
 Cut 1- 7" x WOF strip
 Subcut 1- 6 1/2" x 12 1/2" rectangle 1-Section 4
 1- 7" x 14" rectangle* 1-Section 3



Backing 4 yds. pieced across

Cutting

Fabric 11 Purple/Tan Print

- Cut 1– 8½" x WOF strip
 Subcut 1– 8½" x 42½" strip
- Cut 1– 7" x 1 WOF strip
 Subcut 2– 6½" x 12½" rectangles
 2– 6⅞" x 6⅞" square, cut once diagonally

Fabric 12 Blue Large Floral

- Cut 2– 8½" x WOF strips
 Subcut 1– 8½" x 20½" strip
 1– 8½" x 30½" strip

Fabric 13 Blue Squares

- Cut 1– 7" x WOF strip
 Subcut 1– 6½" x 12½" rectangle
 1– 7" x 14" rectangle*
 2– 6½" x 6½" squares
- Cut 1– 10" x WOF strip
 Subcut 1– 10" x 11" rectangle
 1– 6⅞" x 6⅞" square, cut once diagonally
1 extra piece

Fabric 14 Green/Red Flower Print

- Cut 2– 7" x WOF strips
 Subcut 1– 7" x 14" rectangle*
 2– 6½" x 12½" rectangles
 2– 6⅞" x 6⅞" squares, cut once diagonally
1 extra piece

Fabric 15 Cream/Red Flower Print

- Cut 2– 7" x WOF strips
 Subcut 2– 7" x 14" rectangles*
 6– 6½" x 6½" squares
- 2– 6⅞" x 6⅞" squares, cut once diagonally
1 extra piece

Fabric 16 Cream/Purple Print

- Cut 2– 7" x WOF strips
 Subcut 1– 7" x 14" rectangle*
 4– 6½" x 6½" squares
- 3– 6⅞" x 6⅞" squares, cut once diagonally
1 extra piece

Fabric 17 Brown Small Floral

- Cut 1– 7" x WOF strip
 Subcut 1– 7" x 14" rectangle*
 1– 6½" x 12½" rectangles
 2– 6⅞" x 6⅞" squares, cut once diagonally
1 extra piece
Use remaining fabric for applique stems

LABEL

Top Border

- 2-Section 4
 1-Section 1
 1- Section 2
 2- Section 4

Top Border
 Sect. 1 Border

- 1- Section 4
 1- Section 1
 2-Section 4

Applique Vase
 1- Section 1

- 1- Section 1
 2- Section 2
 1- Section 1
 1- Section 2
 1- Section 4

- 1- Section 3
 1- Section 4
 2-Section 2
 2- Section 3
 2- Section 4
 2- Section 1
 1- Section 4

- 1- Section 3
 2-Section 2
 2- Section 4
 2- Section 1
 1- Section 3
 2- Section 4

- 1- Section 3
 1- Section 4
 1- Section 1
 1- Section 3
 1- Section 4

Fabric 18 Green Squares

- Cut 2– 7" x WOF strips
 Subcut 1– 7" x 14" rectangle*
 1– 6½" x 12½" rectangles
 4– 6½" x 6½" squares

LABEL

- 1- Section 3
 1- Section 3
 2-Section 4
 2- Section 3 Border

3 – ⅝ Yard Cuts

Fabric 19 Purple Large Floral

- Cut 1– 9" x WOF strip
 Subcut 1– 9" x 9" square
 1– 8½" x 18½" border strip
- Cut 1– 8½" x WOF strip
 Subcut 1– 8½" x 38½" border strip

- 1- Section 1
 1- Section 4
 Bottom Border

Fabric 20 Tan/Pink Floral

- Cut 3– 7" x WOF strips
 Subcut 2– 7" x 14" rectangle*
 6– 6½" x 6½" squares
 3– 6⅞" x 6⅞" squares, cut once diagonally
1 extra piece
 2– 6½" x 8½" rectangles

- 1- Section 3
 1- Section 4
 4-Section 2
 2- Bottom Border
 2- Section 1
 1- Section 2
 2- Section 3

Fabric 21 Cream Dot

- Cut 1– 14" x WOF strip
 Cut 1– 14" x 14" square, cut twice diagonally
1 extra piece
- From remainder of strip cut:*

- 1– 6½" x 12½" rectangles
 6– 6½" x 6½" squares 2 each to Sections 2,3,4
- Cut 1– 7" x WOF strip
 Subcut 1– 6⅞" x 6⅞" squares,
 cut once diagonally

- 1- Section 1
 2- Section 3
 1- Section 4
 1- Section 1
 1- Section 2

2 – ⅞ Yard Cuts

Fabric 22 (2636-12) Red Stripe

- Cut 1– 6½" x WOF strip
 Subcut 2– 6½" x 12½" rectangles
 2– 6½" x 6½" squares 1 ea. to Sections 2 & 3
 2-Section 4
- Cut 8– 2½" x WOF strips for Binding

Fabric 23 (2636-11) Tan Stripe

- First cut 1 – 27" x 20" rectangle for applique background.
Note: Trim background to 18½" x 24½" when applique is complete.
 From remaining fabric cut:
- 3– 6⅞" x 6⅞" squares, cut once diagonally
1 extra piece

- 1- Section 1
 2- Section 2
 1- Section 3
 1- Section 4

and 1 – 10" x 10" square for applique bkgd.
 – trim to 9" x 9" when applique is complete.

** All 7" x 14" rectangles will be cut into quarter square triangles. See box on back page.*

Construction

This quilt is built in sections. Gather pieces for each section before beginning construction.



SECTION 1

12 1/2" x 24 1/2" unit

PIECES FOR SECTION 1

- (1) Section 1 Border Strip – 8 1/2" x 30 1/2"
- (1) Completed applique block trimmed to 18 1/2" x 24 1/2"
- (20) Half Square Triangles
- (1) 1– 9" x 9" floral square
- (6) Quarter Square Triangles

1. Pair and piece 20 half square triangles into 10 half square triangle blocks. Refer to quilt image for color placement and direction. Press.
2. Arrange half square triangle blocks and sew 1 column of 4 blocks and 1 row of 6 blocks. Press.
3. Sew a quarter square triangle to opposite sides of 9" x 9" floral square. Press. *Note triangle is slightly larger. Align with edge of 9" block.*
4. Select 2 quarter square triangles and join on short side. See diagram. Repeat with remaining quarter square triangles. Press.
5. Matching seams, add 1 set of quarter square triangles opposite sides of Step 3 unit. Press. *Trim pieced section to measure 12 1/2" x 24 1/2" with seams.*
6. Join applique block and quarter square triangle unit from Step 5. Press.
7. Add 4 column of half square triangle blocks to opposite side of applique block. Press.
8. Add remaining half square triangle row to top of applique unit. Press.
9. To complete Section 1, add 8 1/2" x 30 1/2" border strip to half square triangle side of section. Press.

STEP 3

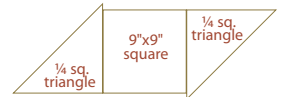

Note: triangles are slightly larger than square. Align with edge of square.

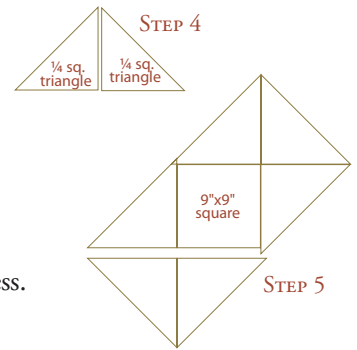

STEP 4

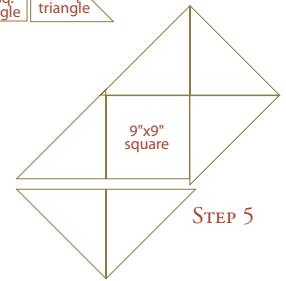

Section 1 should measure 38 1/2" x 42 1/2" with seams.

SECTION 2

moda

MAKE FLYING GEESE BLOCKS

1. Using a mechanical pencil, draw a diagonal line on the wrong side of the 10–6 1/2" x 6 1/2" squares.
2. With right sides together, align edges of 6 1/2" x 12 1/2" rectangle and a 6 1/2" x 6 1/2" marked square. *Note direction of marked line.*
3. Stitch on marked line.
4. Trim away extra fabric from square leaving a 1/4" seam.
5. Press toward corner to make triangle. Repeat on opposite corner.
6. Make 5 flying geese blocks. Arrange and sew into a column of 5. Press.
7. Arrange and sew 10 half square triangles into 5 half square triangle blocks. Press.
8. Sew half square triangle blocks into a column of 5. Press.
9. Join half square triangle column and flying geese column. Press. *See quilt image for placement.*

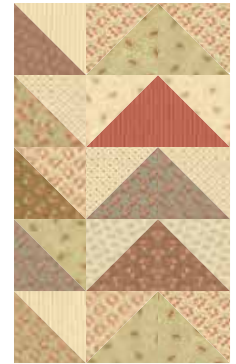

PIECES FOR SECTION 2

- (5) 6 1/2" x 12 1/2" rectangles for flying geese
- (10) 6 1/2" x 6 1/2" squares for flying geese
- (10) Half Square Triangles

Section 2 should measure 18 1/2" x 30 1/2" with seams.

STEPS 2-4

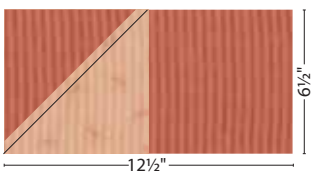

STEPS 5

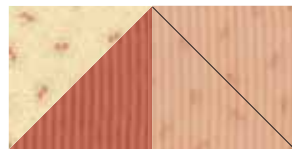

Make 5 flying geese blocks

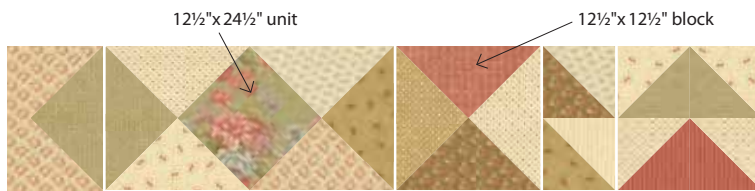

SECTION 3

1. Use 4-6½" x 6½" squares and 2-6½" x 12½" rectangles to make 2 flying geese blocks. Press. Stack and stitch blocks. Press.
2. Pair and stitch half square triangles to make 2 half square triangle blocks. Press. Stack and stitch blocks. Press. Add to side of flying geese blocks. Press.
3. Select and piece 4 quarter square triangles into 1 block. Press. *Trim block to measure 12½" x 12½" with seams See diagram.* Add quarter square triangle block to Step 2 unit.
4. Sew a quarter square triangle to opposite sides of 9" x 9" floral square. Press.
5. Select 2 quarter square triangles and join on short side. See diagram. Repeat with remaining quarter square triangles. Be sure to sew on opposite short side. Press.
6. Add 1 set of quarter square triangles to opposite sides of Step 4 unit. Press. Pieced section should measure 12½" x 24½" with seams.
7. Add pieced section to first quarter square triangle block. Press.

PIECES FOR SECTION 3

- (2) 6½" x 8½" rectangles
- (2) 6½" x 12½" rectangles
- (6) 6½" x 6½" squares
- (4) half square triangles
- (1) 9" x 9" floral square
- (10) quarter square triangles

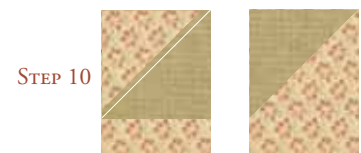
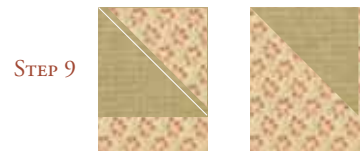

Pieced Border Unit

MAKING PIECED BORDER BLOCKS

8. Using a mechanical pencil, draw a diagonal line on the wrong side of the 2 remaining 6½" x 6½" squares.
9. With right sides together align edges of 1-6½" x 6½" square and 1-6½" x 8½" rectangle. *Note direction of line. See illustration.* Stitch on marked line. Trim seam as with flying geese blocks.
10. Repeat Step 9, but make sure marked line is running in opposite direction. Trim and press.
11. Join blocks and add to other units to complete Section 3.

Section 3 should measure 62½" x 12½" with seams.

PIECES FOR SECTION 4

- (1) Section 4 Border Strip – 8½" x 18½"
- (6) 6½" x 12½" rectangles
- (12) 6½" x 6½" squares
- (14) half square triangles
- (1) 9" x 9" appliqued block
- (6) quarter square triangles

SECTION 4



Section 4 should measure 62½" x 18½" with seams.

1. Make 6 flying geese units using 12-6½" x 6½" squares and 6-6½" x 12½" rectangles. Press.
2. Join flying geese units into 2 columns of three.
3. Pair and stitch 7 half square triangle blocks.
4. Join blocks into 1 row of 7 half square triangle blocks. Press.
5. Add sampler quarter square triangles to opposite sides of appliqued block. *Note direction of letters.* Press.
6. Pair 4 remaining quarter square triangles, noting direction of letters, and stitch on short sides of triangle. Press.
7. Add to opposite sides of pieced applique unit. *Trim pieced unit to measure 12½" x 24½" with seams. See SECTION 1.*
8. Stitch 1 set of flying geese blocks to side of applique unit. Press.
9. Add half square triangle row to bottom of Step 8 unit. Press.
10. Add border 8½" x 18½" squares border strip to left side of combined unit and the remaining set of flying geese to right side to complete Section 4.

Construction cont.



1. Join the two border strips. Floral border strips should be on the left. Press. Top border should measure $8\frac{1}{2}'' \times 62\frac{1}{2}''$ with seams.

Top Border should measure $8\frac{1}{2}'' \times 62\frac{1}{2}''$ with seams.

PIECES FOR TOP BORDER

- (1) $8\frac{1}{2}'' \times 20\frac{1}{2}''$ strip
- (1) $8\frac{1}{2}'' \times 42\frac{1}{2}''$ strip



1. Make 2 pieced border blocks using the $2-6\frac{1}{2}'' \times 6\frac{1}{2}''$ squares and the $2-6\frac{1}{2}'' \times 8\frac{1}{2}''$ rectangles. If needed, see Section 3 for directions.
2. Join blocks. Press.
3. Stitch $8\frac{1}{2}'' \times 12\frac{1}{2}''$ border strip to end of $8\frac{1}{2}'' \times 38\frac{1}{2}''$ border strip. Press. Then add pieced block unit to complete bottom border.

Bottom Border should measure $8\frac{1}{2}'' \times 62\frac{1}{2}''$ with seams.

PIECES FOR BOTTOM BORDER

- (1) $8\frac{1}{2}'' \times 38\frac{1}{2}''$ strip
- (1) $8\frac{1}{2}'' \times 12\frac{1}{2}''$ strip
- (2) $6\frac{1}{2}'' \times 8\frac{1}{2}''$ rectangles
- (2) $6\frac{1}{2}'' \times 6\frac{1}{2}''$ squares

Assemble Quilt

1. Stitch Section 1 and Section 2 together. Press.
2. Add Top Border to top of combined Section 1 and Section 2 unit.
3. Then add Section 3 followed by Section 4. Press.
4. Finally add the Bottom Border to Section 4 to complete quilt top. Press.

Quilt Top should measure $62\frac{1}{2}'' \times 76\frac{1}{2}''$ with seams.

finishing

1. Prepare binding.
2. Layer, Quilt and Bind.

CUTTING A QUARTER SQUARE TRIANGLE FROM A 7" X 14" RECTANGLE

CUTTING A QUARTER SQUARE TRIANGLE

1. Fold 7" x 14" rectangle in half wrong sides together. Fold on the long side. Press.
2. With fold on the left, align rotary ruler with the upper left and lower right corners of the folded rectangle.
3. Cut with rotary cutter and unfold to make 1 quarter square triangle.

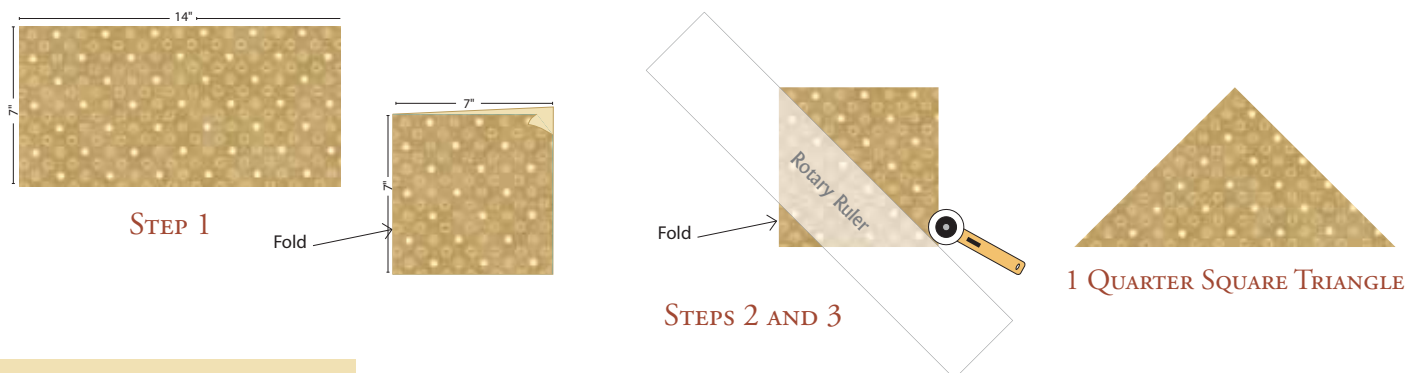

moda
PS2630 — SUGGESTED RETAIL \$2.00
www.modafabrics.com

5. Follow the steps above to make Quarter Square Triangles from **all** 7" x 14" rectangles. **Total 13** from Fabrics 3, 8, 10, 13, 14, 15, 16, 17, 18 and 20.



Beach House

by Blackbird Designs



applique templates

Enlarge Templates 200%
templates do not include seam allowance

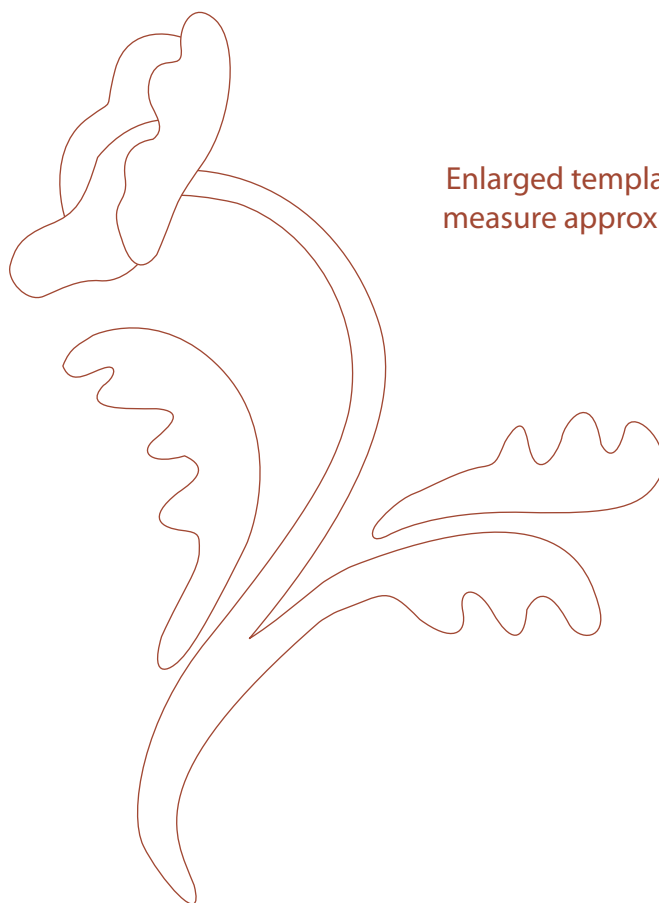

Enlarged template should
measure approx. 6¼" x 9¼"

Cut 1 of Each



Enlarged template should
measure approx. 16½"x21½"

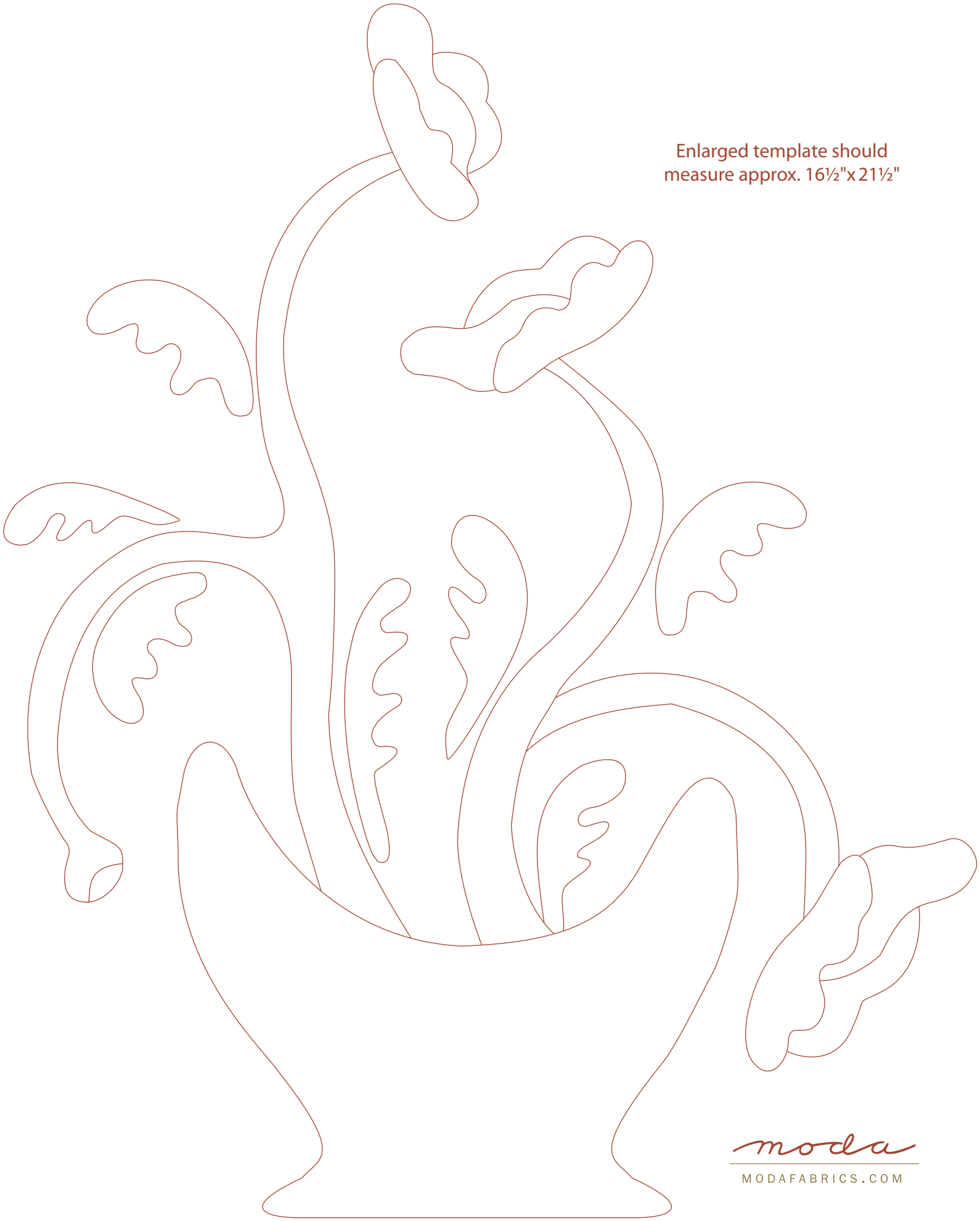

moda

MODAFABRICS.COM

